



# JEYPORE COLLEGE OF PHARMACY

(Under the patronage of Banagiri Development Trust)  
Approved by Government of Odisha, Pharmacy Council of India, New Delhi  
& Affiliated to Biju Patnaik University of Technology

Ref No.:

Date:

## COLLEGE BUILDING PLAN

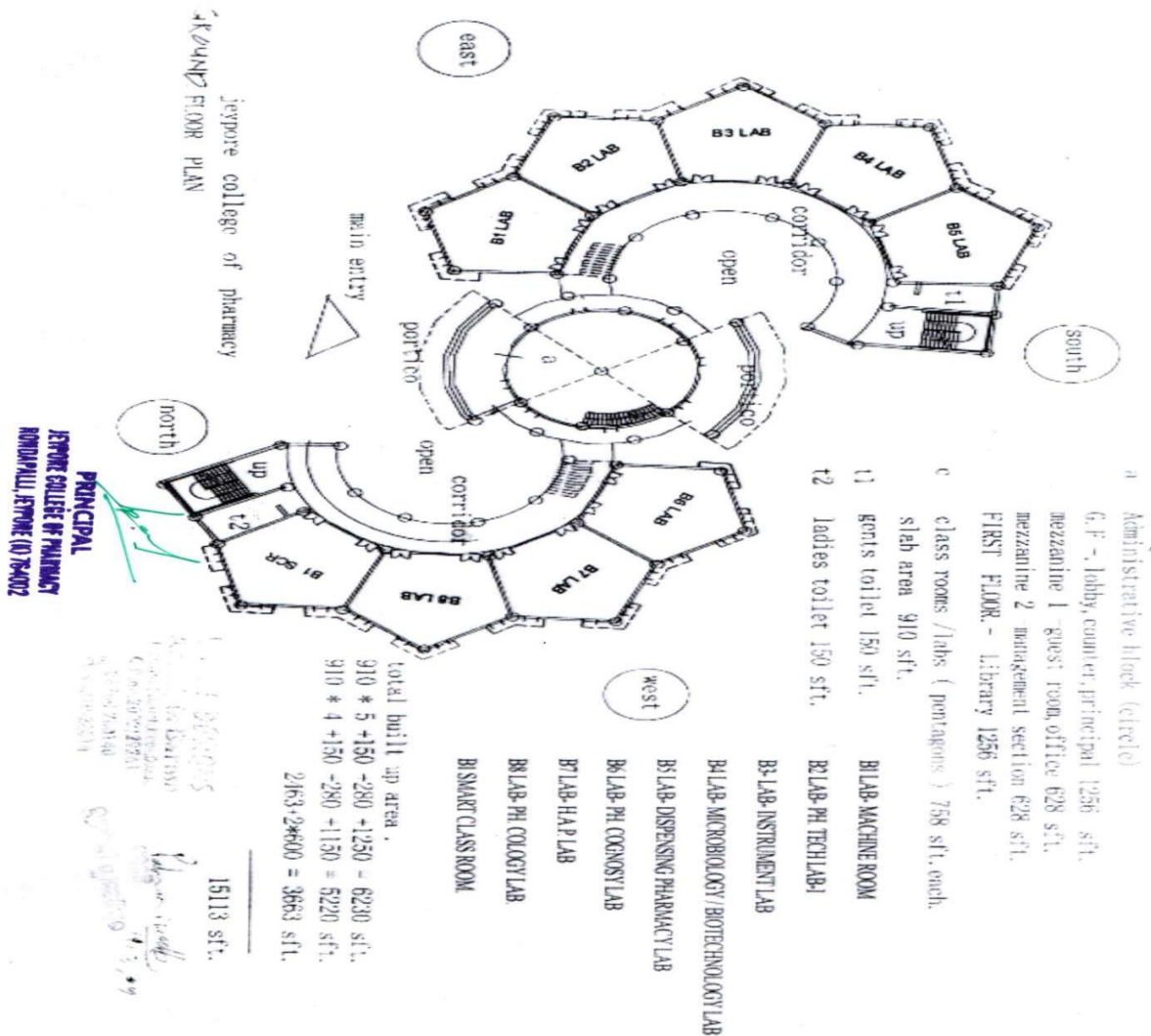



# JEYPORE COLLEGE OF PHARMACY

(Under the patronage of Banagiri Development Trust)  
 Approved by Government of Odisha, Pharmacy Council of India, New Delhi  
 & Affiliated to Biju Patnaik University of Technology

Ref No.:

Date:

## COLLEGE BUILDING PLAN

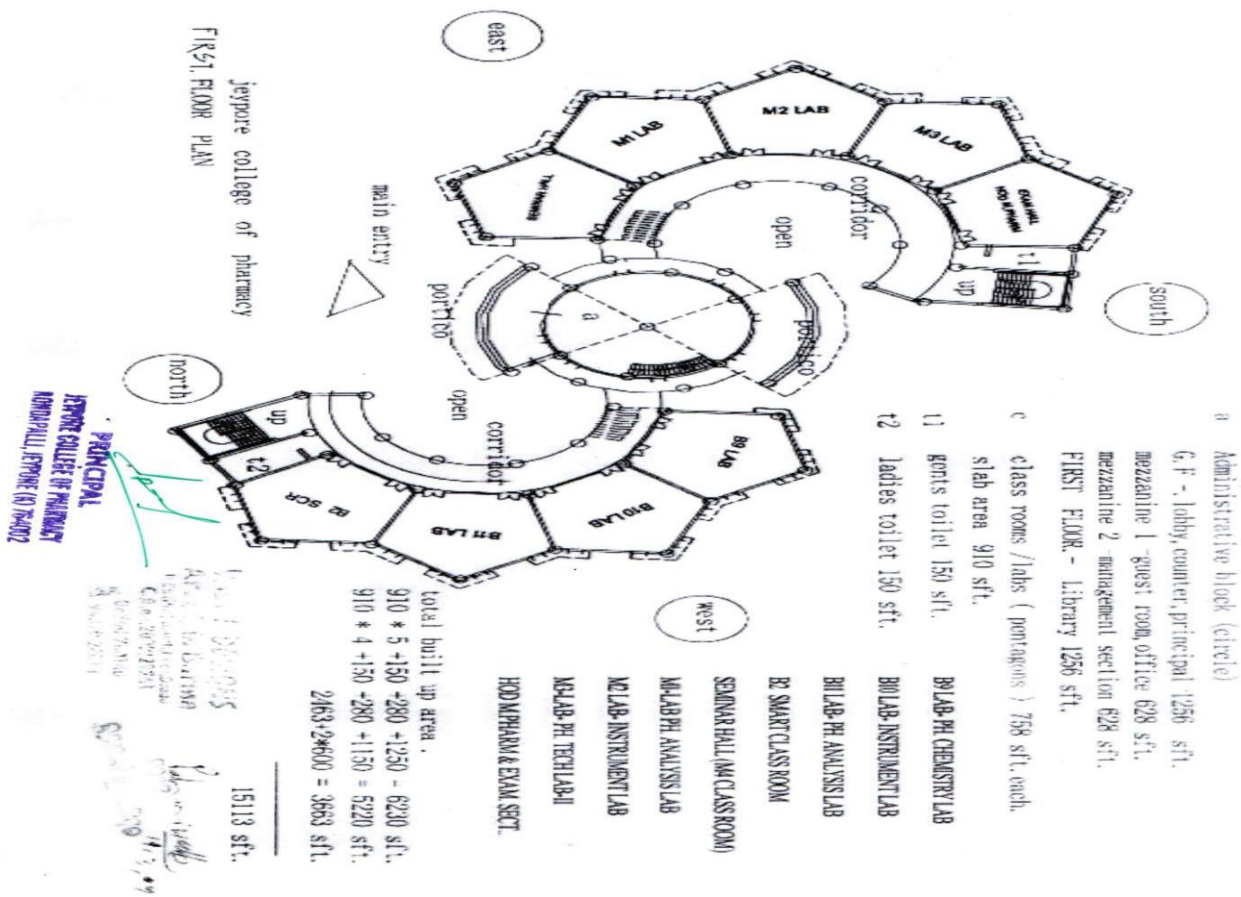





# JEYPORE COLLEGE OF PHARMACY

(Under the patronage of Banagiri Development Trust)  
Approved by Government of Odisha, Pharmacy Council of India, New Delhi  
& Affiliated to Biju Patnaik University of Technology

Ref No.:

Date:

## UG CLASS ROOMS LIST AND MEASUREMENTS

SL.NO	COURSE	CLASS ROOM	AREA IN Sq.meters
01	B.PHARM	B1 SMART CLASS ROOM	85.2
02	B.PHARM	B2 SMART CLASS ROOM	85.2
03	B.PHARM	B3 CLASS ROOM WITH ICT FACILITY	85.2
04	B.PHARM	B4 CLASS ROOM WITH ICT FACILITY	85.2

*P. Mohapatra*

**PRINCIPAL**

**JEYPORE COLLEGE OF PHARMACY  
RONDAPALLI, JEYPORE (K) 764002**



# JEYPORE COLLEGE OF PHARMACY

(Under the patronage of Banagiri Development Trust)  
Approved by Government of Odisha, Pharmacy Council of India, New Delhi  
& Affiliated to Biju Patnaik University of Technology

Ref No.:

Date:

## PG CLASS ROOMS AND MEASUREMENTS

SL.NO	COURSE	CLASS ROOM	AREA IN Sq.meters
01	M.PHARM	M1 CLASS ROOM	42.6
02	M.PHARM	M2 CLASS ROOM	42.6
03	M.PHARM	M3 CLASS ROOM	85.2

SL.NO	SEMINAR HALL	AREA IN Sq.meters
01	SEMINAR HALL / M4 CLASS ROOM	85.2

*P. Mishra*  
**PRINCIPAL**  
**JEYPORE COLLEGE OF PHARMACY**  
**RONDAPALLI, JEYPORE (K) 764002**





# JEYPORE COLLEGE OF PHARMACY

(Under the patronage of Banagiri Development Trust)  
Approved by Government of Odisha, Pharmacy Council of India, New Delhi  
& Affiliated to Biju Patnaik University of Technology

Ref No.:

Date:

## UG PRACTICAL LABS

SL.N O	PRATIC AL LABS (FOR UG COURSE)	NAME OF THE LAB	AREA IN Sq.Mete rs
01	LAB-B1	MACHINE ROOM	85.2
02	LAB-B2	PHARMA TECHNOLOGY-I	85.2
03	LAB-B3	INSTRUMENT LAB	85.2
04	LAB-B4	MICROBIOLOGY/BIOTECHNO LOGY	85.2
05	LAB-B5	DISPENSING PHARMACY	85.2
06	LAB-B6	PHARMACOGNOSY	85.2
07	LAB-B7	H.A.P	85.2
08	LAB-B8	PHARMACOLOGY	85.2
09	LAB-B9	PHARMA CHEMISTRY	85.2
10	LAB-B10	INSTRUMENT LAB-I	85.2
11	LAB-B11	PHARMA ANALYSIS	85.2

*P. Mohapatra*

**PRINCIPAL**  
**JEYPORE COLLEGE OF PHARMACY**  
**RONDAPALLI, JEYPORE (K) 764002**



# JEYPORE COLLEGE OF PHARMACY

(Under the patronage of Banagiri Development Trust)  
Approved by Government of Odisha, Pharmacy Council of India, New Delhi  
& Affiliated to Biju Patnaik University of Technology

Ref No.:

Date:

## PG PRACTICAL LABS

SL.NO	PRATICAL LABS (FOR PG COURSE)	NAME OF THE LAB	AREA IN Sq.Meters
01	LAB-M1	PHARMA ANALYSIS	85.2
02	LAB-M2	INSTRUMENT LAB-II	85.2
03	LAB-M3	PHARMA TECHNOLOGY-II	85.2
04	LAB-M4	PHARMACOLOGY	85.2
05	LAB-M5	PHARMACOGNOSY	85.2

*P. Mishra*  
**PRINCIPAL**  
**JEYPORE COLLEGE OF PHARMACY**  
**RONDAPALLI, JEYPORE (K) 764002**



# JEYPORE COLLEGE OF PHARMACY

(Under the patronage of Banagiri Development Trust)  
Approved by Government of Odisha, Pharmacy Council of India, New Delhi  
& Affiliated to Biju Patnaik University of Technology

Ref No.:

Date:

## SMART CLASS ROOM

### B1-CLASS ROOM



*P. Mishra*  
**PRINCIPAL**  
**JEYPORE COLLEGE OF PHARMACY**  
**RONDAPALLI, JEYPORE (K) 764002**





# JEYPORE COLLEGE OF PHARMACY

(Under the patronage of Banagiri Development Trust)  
Approved by Government of Odisha, Pharmacy Council of India, New Delhi  
& Affiliated to Biju Patnaik University of Technology

Ref No.:

Date:

## B2-CLASS ROOM



*P. Mohapatra*

**PRINCIPAL**  
**JEYPORE COLLEGE OF PHARMACY**  
**RONDAPALLI, JEYPORE (K) 764002**

Rondapalli, Jeypore, Dist. Koraput-764 002, Odisha  
Ph: (06854) 291221, Admission Cell: 7978484794, 7978494262  
Visit us: [www.jcp.ac.in](http://www.jcp.ac.in) E-mail: [jcpprincipal2001@gmail.com](mailto:jcpprincipal2001@gmail.com)



# JEYPORE COLLEGE OF PHARMACY

(Under the patronage of Banagiri Development Trust)  
Approved by Government of Odisha, Pharmacy Council of India, New Delhi  
& Affiliated to Biju Patnaik University of Technology

Ref No.:

Date:

## B3-CLASS ROOM WITH O.H.P



Jeypore, Odisha, India  
Whj7+x3p, Bana Vihar, Rondapali, Jeypore, Odisha 764002, India  
Lat 18.932621° Long 82.562555°  
07/02/24 02:00 PM GMT +05:30

Google

*P. Mohapatra*

**PRINCIPAL**  
**JEYPORE COLLEGE OF PHARMACY**  
**RONDAPALLI, JEYPORE (K) 764002**

Rondapalli, Jeypore, Dist. Koraput-764 002, Odisha  
Ph: (06854) 291221, Admission Cell: 7978484794, 7978494262  
Visit us: [www.jcp.ac.in](http://www.jcp.ac.in) E-mail: [jcpprincipal2001@gmail.com](mailto:jcpprincipal2001@gmail.com)





# JEYPORE COLLEGE OF PHARMACY

(Under the patronage of Banagiri Development Trust)  
Approved by Government of Odisha, Pharmacy Council of India, New Delhi  
& Affiliated to Biju Patnaik University of Technology

Ref No.:

Date:

## B4-CLASS ROOM WITH O.H.P



Jeypore, Odisha, India  
Whm7+344, Bana Vihar, Jeypore, Mazurmunda, Odisha 764002,  
India  
Lat 18.93269° Long 82.562764°  
07/02/24 03:27 PM GMT +05:30

GPS Map Camera



*P. Mohapatra*  
**PRINCIPAL**  
**JEYPORE COLLEGE OF PHARMACY**  
**RONDAPALLI, JEYPORE (K) 764002**

Rondapalli, Jeypore, Dist. Koraput-764 002, Odisha  
Ph: (06854) 291221, Admission Cell: 7978484794, 7978494262  
Visit us: [www.jcp.ac.in](http://www.jcp.ac.in) E-mail: [jcpprincipal2001@gmail.com](mailto:jcpprincipal2001@gmail.com)



# JEYPORE COLLEGE OF PHARMACY

(Under the patronage of Banagiri Development Trust)  
Approved by Government of Odisha, Pharmacy Council of India, New Delhi  
& Affiliated to Biju Patnaik University of Technology

Ref No.:

Date:

## SEMINAR HALL WITH O.H.P



Jeypore, Odisha, India  
Whj7+x3p, Bana Vihar, Rondapali, Jeypore, Odisha 764002, India  
Lat 18.932403° Long 82.562716°  
07/02/24 01:47 PM GMT +05:30

Google

GPS Map Camera

*P. Mohapatra*  
**PRINCIPAL**  
**JEYPORE COLLEGE OF PHARMACY**  
**RONDAPALLI, JEYPORE (K) 764002**

Rondapalli, Jeypore, Dist. Koraput-764 002, Odisha  
Ph: (06854) 291221, Admission Cell: 7978484794, 7978494262  
Visit us: [www.jcp.ac.in](http://www.jcp.ac.in) E-mail: [jcpprincipal2001@gmail.com](mailto:jcpprincipal2001@gmail.com)





# JEYPORE COLLEGE OF PHARMACY

(Under the patronage of Banagiri Development Trust)  
Approved by Government of Odisha, Pharmacy Council of India, New Delhi  
& Affiliated to Biju Patnaik University of Technology

Ref No.:

Date:

## HAP PRACTICAL LAB



Jeypore, Odisha, India  
Whj7+x3p, Bana Vihar, Rondapali, Jeypore, Odisha 764002, India  
Lat 18.932488° Long 82.562598°  
07/02/24 02:11 PM GMT +05:30

Google

GPS Map Camera

*P. Mohapatra*  
**PRINCIPAL**  
**JEYPORE COLLEGE OF PHARMACY**  
**RONDAPALLI, JEYPORE (K) 764002**

Rondapalli, Jeypore, Dist. Koraput-764 002, Odisha  
Ph: (06854) 291221, Admission Cell: 7978484794, 7978494262  
Visit us: [www.jcp.ac.in](http://www.jcp.ac.in) E-mail: [jcpprincipal2001@gmail.com](mailto:jcpprincipal2001@gmail.com)





# JEYPORE COLLEGE OF PHARMACY

(Under the patronage of Banagiri Development Trust)  
Approved by Government of Odisha, Pharmacy Council of India, New Delhi  
& Affiliated to Biju Patnaik University of Technology

Ref No.:

Date:

## PHARMACOGNOSY LAB



Jeypore, Odisha, India  
Whj7+x3p, Bana Vihar, Rondapali, Jeypore, Odisha 764002, India  
Lat 18.932503° Long 82.562592°  
07/02/24 02:15 PM GMT +05:30

*P. Mohapatra*

**PRINCIPAL**  
**JEYPORE COLLEGE OF PHARMACY**  
**RONDAPALLI, JEYPORE (K) 764002**

Rondapalli, Jeypore, Dist. Koraput-764 002, Odisha  
Ph: (06854) 291221, Admission Cell: 7978484794, 7978494262  
Visit us: [www.jcp.ac.in](http://www.jcp.ac.in) E-mail: [jcpprincipal2001@gmail.com](mailto:jcpprincipal2001@gmail.com)



# JEYPORE COLLEGE OF PHARMACY

(Under the patronage of Banagiri Development Trust)  
Approved by Government of Odisha, Pharmacy Council of India, New Delhi  
& Affiliated to Biju Patnaik University of Technology

Ref No.:

Date:

## PHARMACEUTICS LAB



Jeypore, Odisha, India  
Whj7+x3p, Bana Vihar, Rondapali, Jeypore, Odisha 764002, India  
Lat 18.932382° Long 82.562839°  
07/02/24 01:09 PM GMT +05:30

*P. Mohapatra*

**PRINCIPAL**  
**JEYPORE COLLEGE OF PHARMACY**  
**RONDAPALLI, JEYPORE (K) 764002**

Rondapalli, Jeypore, Dist. Koraput-764 002, Odisha  
Ph: (06854) 291221, Admission Cell: 7978484794, 7978494262  
Visit us: [www.jcp.ac.in](http://www.jcp.ac.in) E-mail: [jcpprincipal2001@gmail.com](mailto:jcpprincipal2001@gmail.com)





# JEYPORE COLLEGE OF PHARMACY

(Under the patronage of Banagiri Development Trust)  
Approved by Government of Odisha, Pharmacy Council of India, New Delhi  
& Affiliated to Biju Patnaik University of Technology

Ref No.:

Date:

## PHARMACHEMISTRY



GPS Map Camera

Google

Jeypore, Odisha, India  
Whj7+x3p, Bana Vihar, Rondapali, Jeypore, Odisha 764002, India  
Lat 18.932422° Long 82.562676°  
07/02/24 01:07 PM GMT +05:30

*P. Mohapatra*

**PRINCIPAL**  
**JEYPORE COLLEGE OF PHARMACY**  
**RONDAPALLI, JEYPORE (K) 764002**

Rondapalli, Jeypore, Dist. Koraput-764 002, Odisha  
Ph: (06854) 291221, Admission Cell: 7978484794, 7978494262  
Visit us: [www.jcp.ac.in](http://www.jcp.ac.in) E-mail: [jcpprincipal2001@gmail.com](mailto:jcpprincipal2001@gmail.com)



# JEYPORE COLLEGE OF PHARMACY

(Under the patronage of Banagiri Development Trust)  
Approved by Government of Odisha, Pharmacy Council of India, New Delhi  
& Affiliated to Biju Patnaik University of Technology

Ref No.:

Date:

## PHARMACEUTICAL ANALYSIS LAB

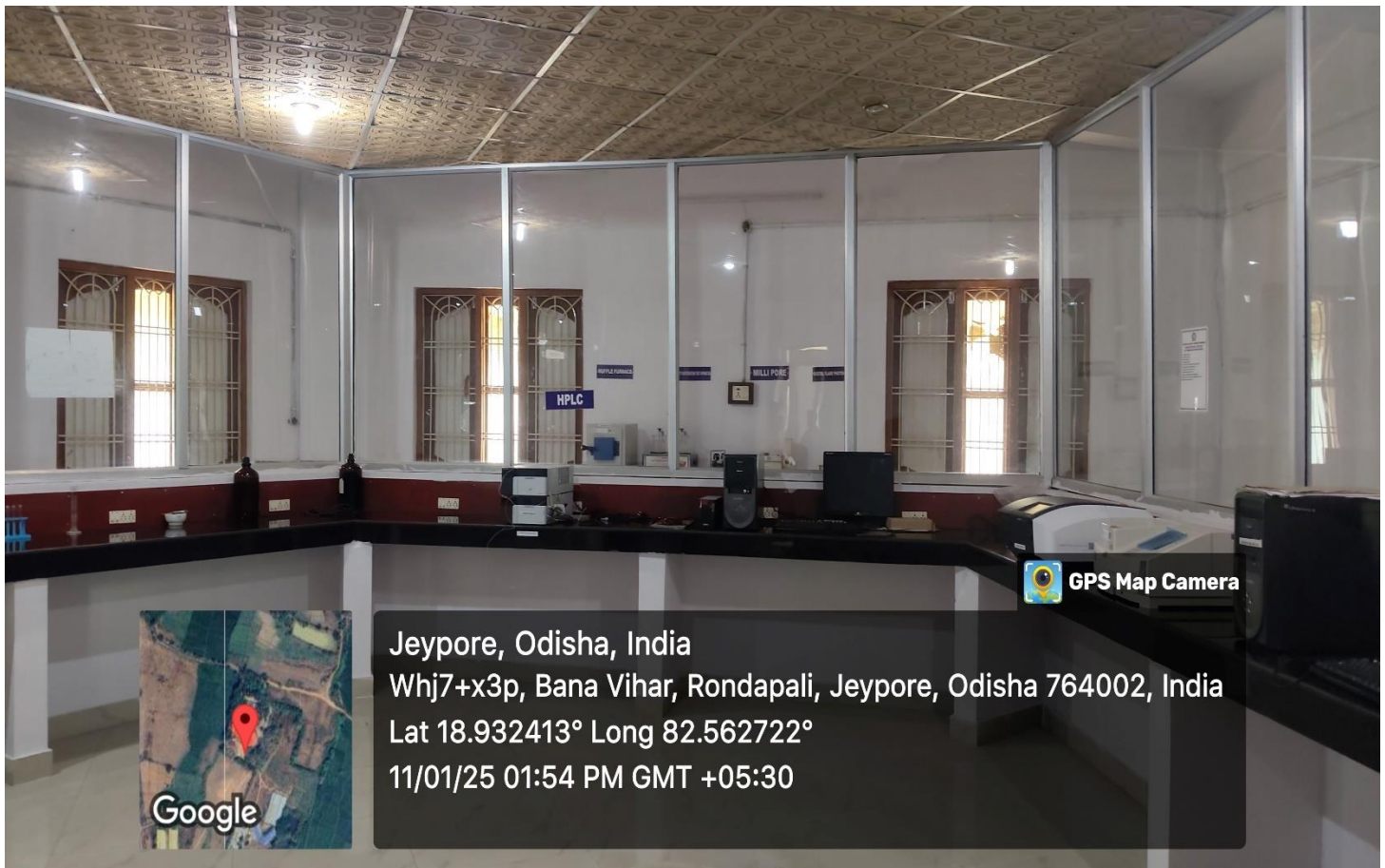

Jeypore, Odisha, India  
Whj7+x3p, Bana Vihar, Rondapali, Jeypore, Odisha 764002, India  
Lat 18.932413° Long 82.562722°  
11/01/25 01:54 PM GMT +05:30

*P. M. Shapari*

**PRINCIPAL**  
**JEYPORE COLLEGE OF PHARMACY**  
**RONDAPALLI, JEYPORE (K) 764002**

Rondapalli, Jeypore, Dist. Koraput-764 002, Odisha  
Ph: (06854) 291221, Admission Cell: 7978484794, 7978494262  
Visit us: [www.jcp.ac.in](http://www.jcp.ac.in) E-mail: jcpprincipal2001@gmail.com





# JEYPORE COLLEGE OF PHARMACY

(Under the patronage of Banagiri Development Trust)  
Approved by Government of Odisha, Pharmacy Council of India, New Delhi  
& Affiliated to Biju Patnaik University of Technology

Ref No.:

Date:

## MICROBIOLOGY LAB

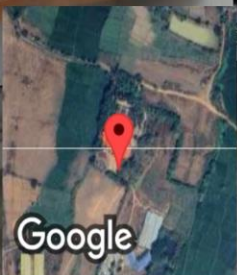
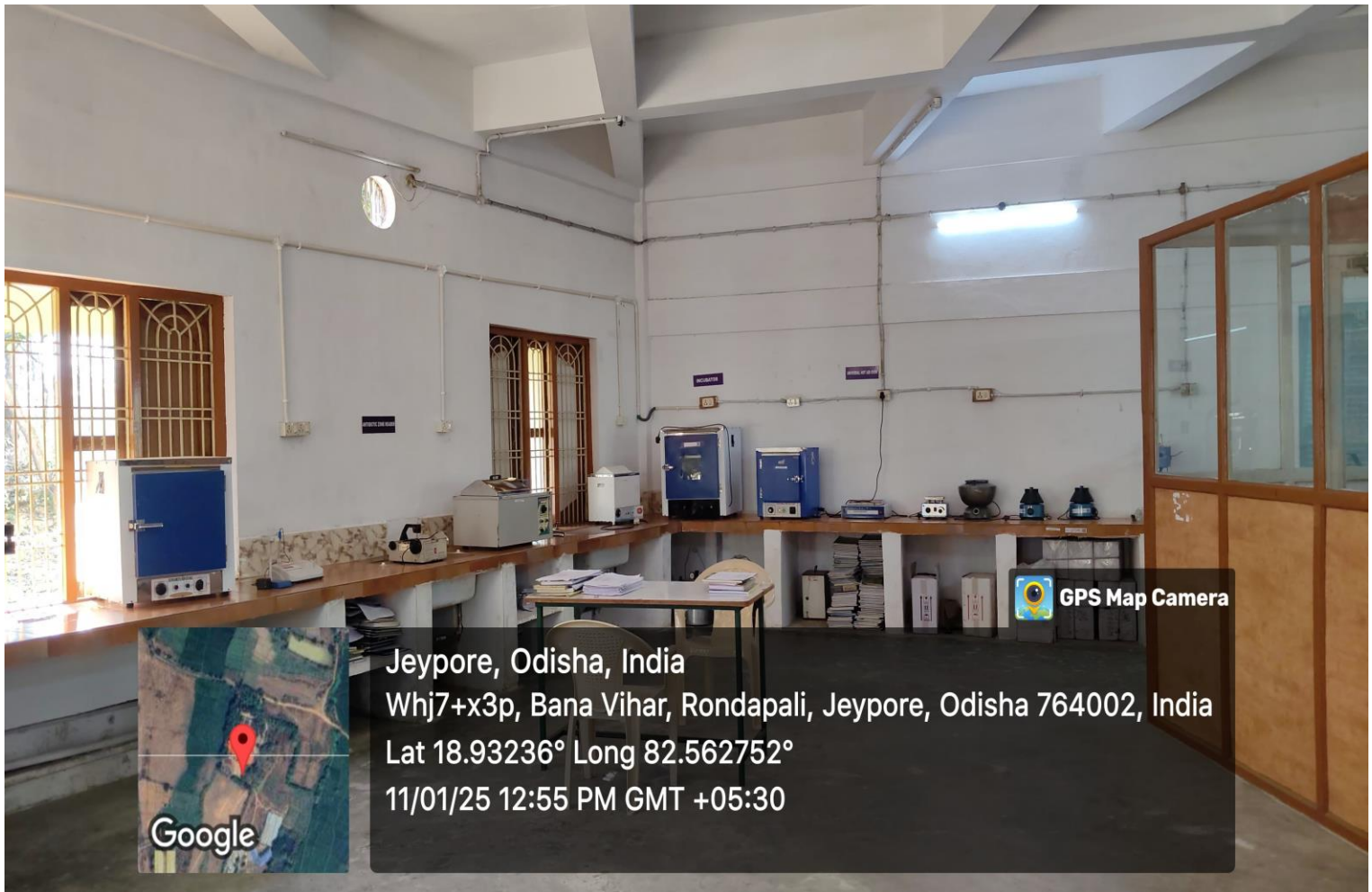

Jeypore, Odisha, India  
Whj7+x3p, Bana Vihar, Rondapali, Jeypore, Odisha 764002, India  
Lat 18.93236° Long 82.562752°  
11/01/25 12:55 PM GMT +05:30

*P. Mohapatra*  
**PRINCIPAL**  
**JEYPORE COLLEGE OF PHARMACY**  
**RONDAPALLI, JEYPORE (K) 764002**

Rondapalli, Jeypore, Dist. Koraput-764 002, Odisha  
Ph: (06854) 291221, Admission Cell: 7978484794, 7978494262  
Visit us: [www.jcp.ac.in](http://www.jcp.ac.in) E-mail: jcpprincipal2001@gmail.com





# JEYPORE COLLEGE OF PHARMACY

(Under the patronage of Banagiri Development Trust)  
Approved by Government of Odisha, Pharmacy Council of India, New Delhi  
& Affiliated to Biju Patnaik University of Technology

Ref No.:

Date:

## ICT FACILITIES

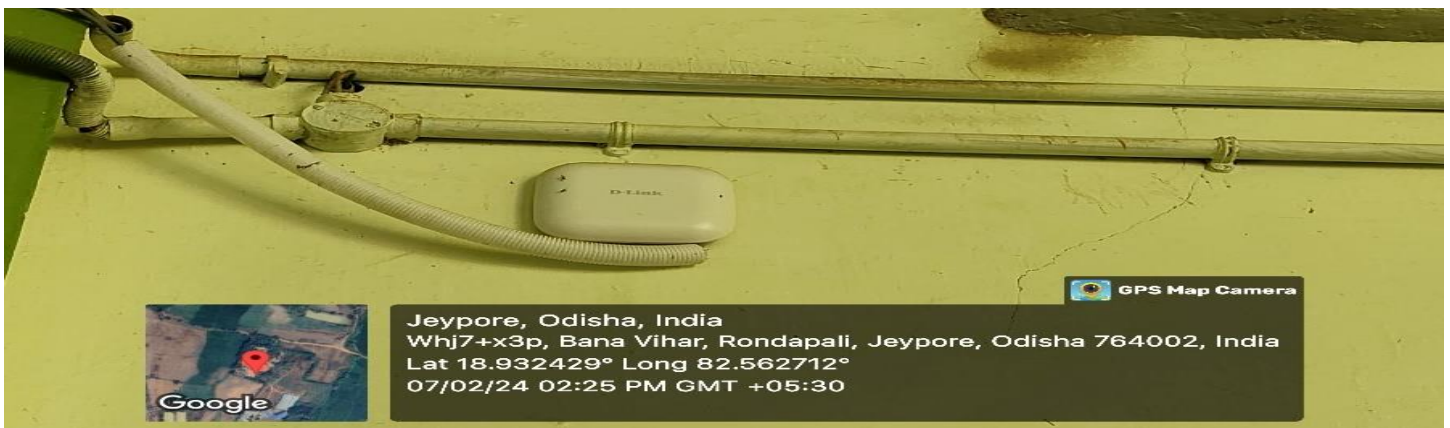

*P. Mohapatra*  
**PRINCIPAL**  
**JEYPORE COLLEGE OF PHARMACY**  
**RONDAPALLI, JEYPORE (K) 764002**

Rondapalli, Jeypore, Dist. Koraput-764 002, Odisha  
Ph: (06854) 291221, Admission Cell: 7978484794, 7978494262  
Visit us: [www.jcp.ac.in](http://www.jcp.ac.in) E-mail: [jcpprincipal2001@gmail.com](mailto:jcpprincipal2001@gmail.com)



# JEYPORE COLLEGE OF PHARMACY

(Under the patronage of Banagiri Development Trust)  
Approved by Government of Odisha, Pharmacy Council of India, New Delhi  
& Affiliated to Biju Patnaik University of Technology

Ref No.:

Date:

## ICT FACILITIES SMART CLASS ROOM

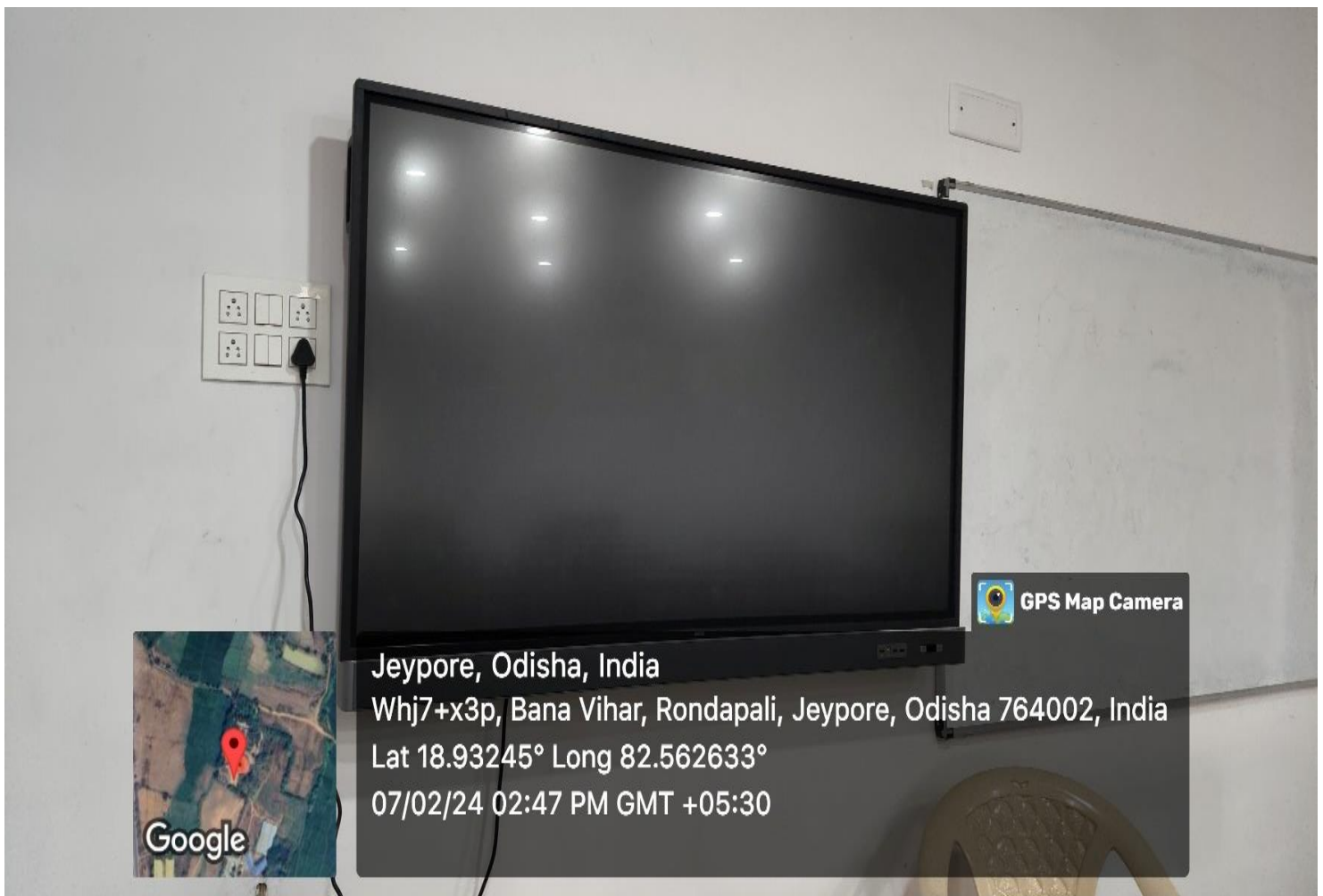

Jeypore, Odisha, India  
Whj7+x3p, Bana Vihar, Rondapali, Jeypore, Odisha 764002, India  
Lat 18.93245° Long 82.562633°  
07/02/24 02:47 PM GMT +05:30



*P. Mohapatra*  
**PRINCIPAL**  
**JEYPORE COLLEGE OF PHARMACY**  
**RONDAPALLI, JEYPORE (K) 764002**

Rondapalli, Jeypore, Dist. Koraput-764 002, Odisha  
Ph: (06854) 291221, Admission Cell: 7978484794, 7978494262  
Visit us: [www.jcp.ac.in](http://www.jcp.ac.in) E-mail: [jcpprincipal2001@gmail.com](mailto:jcpprincipal2001@gmail.com)



# JEYPORE COLLEGE OF PHARMACY

(Under the patronage of Banagiri Development Trust)  
Approved by Government of Odisha, Pharmacy Council of India, New Delhi  
& Affiliated to Biju Patnaik University of Technology

Ref No.:

Date:

## ICT FACILITIES

## CLOSED CIRCUIT TELEVISION SETUP

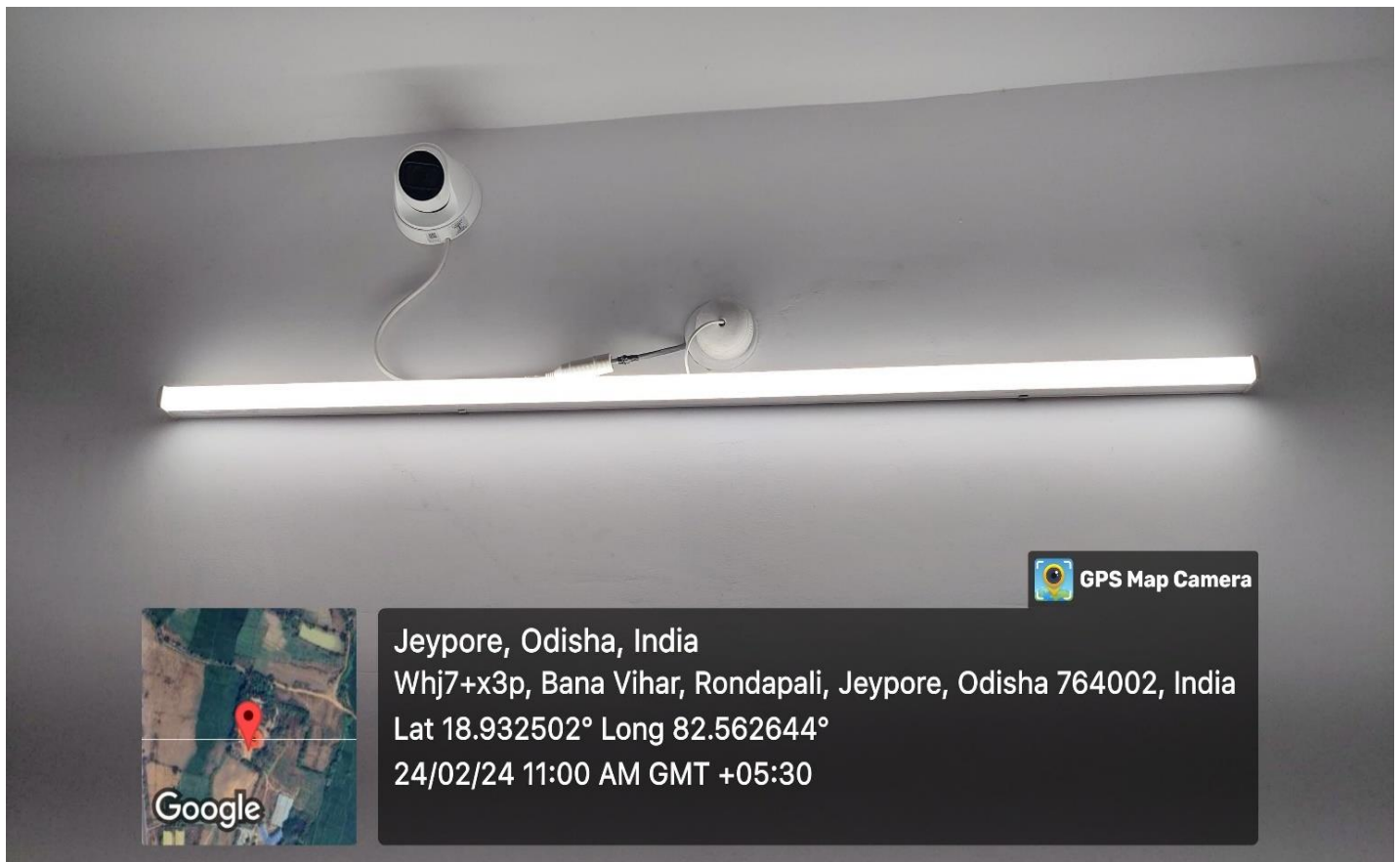

*P. Mohapatra*

**PRINCIPAL**  
**JEYPORE COLLEGE OF PHARMACY**  
**RONDAPALLI, JEYPORE (K) 764002**

Rondapalli, Jeypore, Dist. Koraput-764 002, Odisha  
Ph: (06854) 291221, Admission Cell: 7978484794, 7978494262  
Visit us: [www.jcp.ac.in](http://www.jcp.ac.in) E-mail: [jcpprincipal2001@gmail.com](mailto:jcpprincipal2001@gmail.com)





# JEYPORE COLLEGE OF PHARMACY

(Under the patronage of Banagiri Development Trust)  
Approved by Government of Odisha, Pharmacy Council of India, New Delhi  
& Affiliated to Biju Patnaik University of Technology

Ref No.:

Date:

## ICT FACILITIES

### CLOSED CIRCUIT TELEVISION SETUP



*P. Mohapatra*

**PRINCIPAL**  
**JEYPORE COLLEGE OF PHARMACY**  
**RONDAPALLI, JEYPORE (K) 764002**

Rondapalli, Jeypore, Dist. Koraput-764 002, Odisha  
Ph: (06854) 291221, Admission Cell: 7978484794, 7978494262  
Visit us: [www.jcp.ac.in](http://www.jcp.ac.in) E-mail: [jcpprincipal2001@gmail.com](mailto:jcpprincipal2001@gmail.com)



# JEYPORE COLLEGE OF PHARMACY

(Under the patronage of Banagiri Development Trust)  
Approved by Government of Odisha, Pharmacy Council of India, New Delhi  
& Affiliated to Biju Patnaik University of Technology

Ref No.:

Date:

## LANGUAGE LAB



GEOTAG

*P. Mishra*  
**PRINCIPAL**  
**JEYPORE COLLEGE OF PHARMACY**  
**RONDAPALLI, JEYPORE (K) 764002**

Rondapalli, Jeypore, Dist. Koraput-764 002, Odisha  
Ph: (06854) 291221, Admission Cell: 7978484794, 7978494262  
Visit us: [www.jcp.ac.in](http://www.jcp.ac.in) E-mail: jcpprincipal2001@gmail.com





# JEYPORE COLLEGE OF PHARMACY

(Under the patronage of Banagiri Development Trust)  
Approved by Government of Odisha, Pharmacy Council of India, New Delhi  
& Affiliated to Biju Patnaik University of Technology

Ref No.:

Date:

## GEOTAG IMAGES OF HERBAL GARDEN

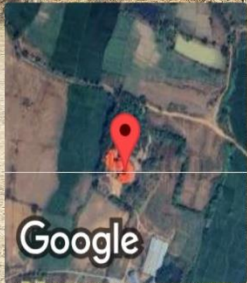

Jeypore, Odisha, India  
Whm7+344, Bana Vihar, Jeypore, Mazurmunda, Odisha 764002,  
India  
Lat 18.932729° Long 82.562798°  
07/02/24 12:37 PM GMT +05:30

GEOTAG IMAGES OF HERBAL GARDEN

*P. Mohapatra*  
**PRINCIPAL**  
**JEYPORE COLLEGE OF PHARMACY**  
**RONDAPALLI, JEYPORE (K) 764002**

Rondapalli, Jeypore, Dist. Koraput-764 002, Odisha  
Ph: (06854) 291221, Admission Cell: 7978484794, 7978494262  
Visit us: [www.jcp.ac.in](http://www.jcp.ac.in) E-mail: jcpprincipal2001@gmail.com





# JEYPORE COLLEGE OF PHARMACY

(Under the patronage of Banagiri Development Trust)  
Approved by Government of Odisha, Pharmacy Council of India, New Delhi  
& Affiliated to Biju Patnaik University of Technology

Ref No.:

Date:

## GEOTAG IMAGES OF HERBAL GARDEN



*P. Mohapatra*  
**PRINCIPAL**  
**JEYPORE COLLEGE OF PHARMACY**  
**RONDAPALLI, JEYPORE (K) 764002**

Rondapalli, Jeypore, Dist. Koraput-764 002, Odisha  
Ph: (06854) 291221, Admission Cell: 7978484794, 7978494262  
Visit us: [www.jcp.ac.in](http://www.jcp.ac.in) E-mail: [jcpprincipal2001@gmail.com](mailto:jcpprincipal2001@gmail.com)